

CORDLESS



ONEPWR™
BATTERY SYSTEM

CLEANSLATE
CORDLESS SPOT CLEANER
(EXCLUDES BATTERY & CHARGER)
F180PSC230

CLEANSLATE PET
CORDLESS SPOT CLEANER
F180PSC23K

USER GUIDE



Product image of overseas model shown.
Australian and New Zealand models feature a battery cover.

IMPORTANT SAFETY INFORMATION

**This machine is intended for household use only and NOT for commercial or industrial use.
PLEASE KEEP INSTRUCTIONS FOR FURTHER USE AND USE ONLY AS INSTRUCTED IN THIS GUIDE.**

- Fully assemble product prior to use.
- Don't leave the charger plugged in when unattended.
- Don't use the machine if it is faulty or has been dropped, damaged or left outdoors.
- Don't use the machine to pick up any flammable or combustible materials (lighter fluid, petrol, kerosene etc.) or use the machine in an area with explosive vapours.
- Don't use the machine to pick up hot coals, cigarette butts, matches or smoking hot burning items or use in an area where there may be harmful fluids (chlorine, bleach and ammonia drain cleaner).
- Don't handle the charger, battery or use the machine with wet hands.
- Don't unplug the charger by pulling on the power cord.
- Don't use the charger if the power cord or plug is damaged.
- Don't attempt to remove blockages with sharp objects as this may cause damage to the machine.
- Don't use the machine with the incorrect battery or charger as this may result in damage or injury to the user.
- Don't charge the battery outdoors, or leave the charger connected to the mains when not in use.
- Don't use the machine with a damaged battery. If the battery is damaged return the machine, battery and charger to the point of purchase.
- Don't over fill the dirty water tank to avoid blocking the air flow through the machine.
- Only Hoover ONEPWR batteries and chargers should be used with this machine.
- Only Hoover ONEPWR recommended tools and accessories should be used with this machine.
- Always remove the battery from the machine before carrying out any maintenance or if storing unused for a long period of time.

IMPORTANT SAFETY INFORMATION

- Keep all openings clear and free from debris as this may affect the airflow/suction.
- Turn off all controls on the machine before disconnecting or connecting the battery.
- Always protect the charger power cord from heated surfaces or near open flames.
- Only use the machine indoors and keep the area you're cleaning well lit.
- The charger power cord cannot be replaced. If the cord is damaged the charger should be scrapped.
- Do not use this charger to charge non-rechargeable batteries.
- This appliance is not intended for use by persons (including children) with reduced physical, sensory or mental capabilities, or lack of experience and knowledge, unless they have been given supervision or instruction concerning use of the appliance by a person responsible for their safety.
- Children should be supervised to ensure that they do not play with the appliance.
- Keep fingers, hair and loose clothing away from moving parts and openings whilst using the machine.
- Store the machine in a cool, dry area. Keep the machine away from rain and moisture.
- Do not place cleaner on stairs or raised platforms, as it may result in injury or damage.
- Use only Australian/New Zealand approved 10amp extension cords/power boards for charging the battery, non-approved extension cords may overheat. Care should be taken to arrange the extension cord as it can be a trip hazard.
- To prevent any damage being sustained, test on an inconspicuous area of the flooring first.
- Do not use without filter and tanks in place.
- Always check the tools/attachments are free from damage, dirt and debris before using.
- To reduce the risk of fire and electric shock due to internal component damage, use only Hoover® cleaning solutions intended for use with this appliance.
- To assist in reducing drying time, be certain the area is well ventilated.
- Water may drip from the tools/attachments after use and may puddle. Take care to avoid damage to wood and laminate flooring and to avoid potential slip hazard.
- This cleaner is only intended for use on sealed hard floors, carpets, and upholstery.

IMPORTANT SAFETY INFORMATION

BATTERY SAFETY PRECAUTIONS

- Replace the battery with a Hoover ONEPWR battery only. Use of another battery may present a risk of fire or explosion.
- Do not attempt to disassemble the battery, remove any component projecting from the battery terminals and do not dispose of in a fire.
- The battery and charger have no user serviceable parts. Do not open, fire or injury may result.
- Prior to disposal, protect exposed terminals with heavy insulating tape to prevent shorting. The battery is to be disposed of safely at your local battery recycling centre.
- When the battery pack is not in use, keep it away from other metal objects that can make a connection from one terminal to another. Shorting the battery terminals together may cause burns or a fire.
- In case of battery leakages avoid any contact with the skin. If liquid comes into contact with the skin, wash immediately with soap and water, then neutralise with lemon juice or vinegar. If liquid gets into the eyes, flush with clean water for at least 10 minutes, then seek immediate medical attention.
- To reduce the risk of fire, personal injury, and product damage due to short circuit, never immerse the tool, battery pack, or charger in fluid or allow fluid to flow inside them. Corrosive or conductive fluids, such as seawater, certain industrial chemicals, and bleach or bleach-containing products, etc., can cause a short circuit.

Technical Specifications	F180PSC23K	F180PSC230
Product Description	Hoover ONEPWR CleanSlate Pet	Hoover ONEPWR CleanSlate (excludes battery & charger)
Console Model Number	BH14010ANZV	BH14010ANZV
Product Weight (without battery pack)	4.4kg	4.4kg
Clean Water Tank Capacity	1.03L	1.03L
Dirty Water Tank Capacity	0.65L	0.65L
Runtime*	Up to 25 mins	NA
Charge Time	3 hours	NA
Charger Model Number	BH05000ANZ	NA
Battery(s) Included	1x 4.0Ah	NA
Battery Model Number	BH29040ANZV	NA
Battery Voltage	18V Li-Ion	18V Li-Ion

Subject to technical change without notice.

* Runtime is based on internal testing. Actual runtime will vary under specific conditions.

COMPATIBLE BATTERY PACKS

MODEL	TYPE	RATED VOLTAGE	RATED CAPACITY	CELL NUMBER
F188TOP21J4	Li-Ion	18V	4.0Ah	5
BH29040ANZ	Li-Ion	18V	4.0Ah	5
BH29040ANZV	Li-Ion	18V	4.0Ah	5

DESCRIPTION OF SYMBOLS



Regulatory
Compliance
Mark



For Indoor
Use Only



Read User
Manual

IPX4

IP Rating

DISTRIBUTED BY:

Techtronic Industries Australia Pty Ltd
31 Gilby Road, Mount Waverley, VIC 3149, Australia
Web Address: www.hoover.com.au
Customer Careline: 1300 698 130

Techtronic Industries N.Z. Limited
Unit C, 70 Business Parade South, East Tamaki, Auckland 2013, New Zealand
Web Address: www.hoover.co.nz
Customer Careline: 0800 126 688

MACHINE OVERVIEW



- 1 Carry handle
- 2 Power On/Off button
- 3 Boost On/Off button
- 4 Power indicator
- 5 Battery dock and cover
- 6 Clean water/solution tank
- 7 Dirty water tank
- 8 Hose
- 9 Clean water/solution tank handle
- 10 Wide Path tool
- 11 Tool release button
- 12 Hose storage clip
- 13 Tight Spot tool storage
- 14 Wide Path tool attachments:
A. Multi-purpose brush
B. Hard floor scrub
- 15 Pet tool*
- 16 2-in-1 tool
- 17 2-in-1 tool attachments:
C. Multi-purpose brush
D. Hard floor scrub
- 18 Tight Spot tool
- 19 ONEPWR battery*
- 20 ONEPWR charger*
- 21 Trial size solution



*Only included with model F180PSC23K.
Contents vary dependant on model purchased.
Images are illustrative only and not to scale.

CHARGING THE BATTERY

THIS MACHINE IS ONLY TO BE USED WITH HOOVER ONEPWR BATTERIES AND CHARGERS. PLEASE READ THE BATTERY AND CHARGER USER GUIDES BEFORE USE.

NOTE: Before first use, ensure the battery is fully charged. Failure to fully charge the battery before first use may result in poor battery performance. The life expectancy of the battery will vary depending on the usage of the machine.



Plug in the charger. Both the red and white LED lights will temporarily illuminate. Attach the battery pack to the charger by aligning the ribs on the battery pack to the grooves on the charger.



The charger light will flash white to show when the battery is charging. The light on the charger will stop flashing and turn off when the battery is fully charged.



Once fully charged, slide the battery off the charger to remove, and unplug the charger from the power point.



To check the battery charge level, press the battery symbol on the battery pack.

NOTE: If the light on the charger flashes red, there is an error with the battery or the charger. Try again or call Customer Service for support on (AUS) 1300 698 130 / (NZ) 0800 126 688.

GETTING STARTED

IMPORTANT: Refer to the floor/surface manufacturer's care recommendations and test all carpets/rugs/upholstery/hard floors before use. Before using the machine to clean dried on stains and dirt, the surface should be vacuumed thoroughly.

Test for colourfastness

Wet a white absorbent cloth with the solution. In a small hidden area of the surfaces to be cleaned, gently rub with the dampened cloth. Wait ten minutes and check for colour removal or bleed with a white paper towel or cloth. Check all surfaces to be cleaned and if the surface has more than one colour, check all colours.

Test the spot cleaner on a small hidden area

If no damage or pile distortion occurs once dry continue cleaning. When using the spot cleaner, basic safety precautions should always be observed and don't over saturate your carpets/rugs/upholstery/hard floors. Not suitable for use on water sensitive flooring/surfaces. Only use with Hoover cleaning solution. Using other solutions may cause excess foaming and damage your machine. The clean water/solution tank should only be filled with warm water (max 40°C). Filling the clean water/solution tank with hot/boiling water will damage your machine.

ASSEMBLY

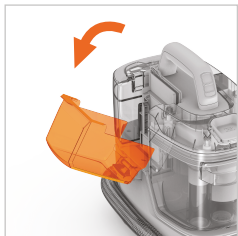

Pull to open the battery cover.

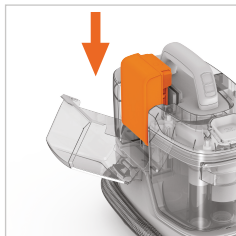

Holding the cover open, slide the battery into the machine until it clicks into place.

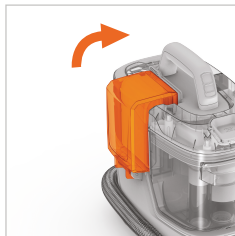

Close the battery cover.

DON'T FORGET YOUR SOLUTIONS

PICK UP HOOVER® SOLUTIONS
FOR PROVEN PERFORMANCE



TO VIEW THE FULL HOOVER® SOLUTIONS RANGE VISIT

HOOVER.COM.AU / HOOVER.CO.NZ

FILLING THE CLEAN WATER/SOLUTION TANK



Lift the clean water/solution tank handle and pull to remove the tank.

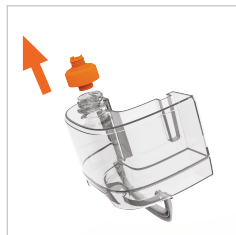

Unscrew the cap off the base of the clean water/solution tank.



Fill the tank with warm water (max 40°C) and solution to the desired clean level, indicated by the lines on the tank.

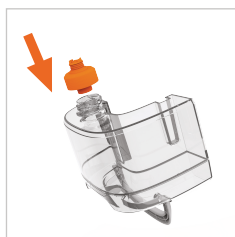
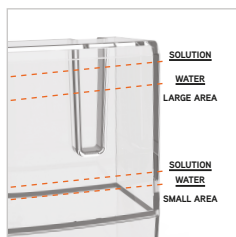

Screw the cap back tightly onto the clean water/solution tank.

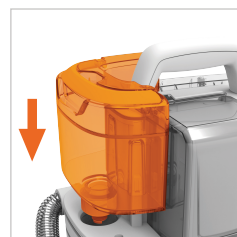

Refit the clean water/solution tank onto the machine so it clicks into place.

NOTE: To view the full Hoover® solutions range visit www.hoover.com.au or www.hoover.co.nz

OPERATION



Pull to remove the wash tool and hose from the storage clip.



Press the on/off button to switch the machine on. The power indicator will illuminate.



Press the + button to increase the suction for particularly dirty areas.

NOTE: Use of the boost mode will reduce the battery runtime.



When less than 20% charge is remaining the power indicator will flash red indicating the battery is running low and charging is required.

USING YOUR MACHINE

USING THE TOOLS/ATTACHMENTS

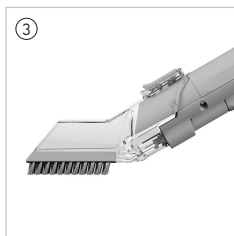
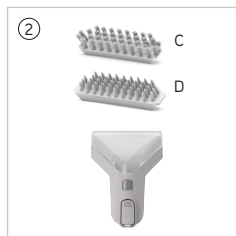
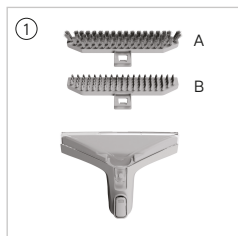

Select the right tool for the job:

1. Wide Path tool

- A) Multi-purpose brush attachment for cleaning carpets, rugs, sofas and upholstery.
- B) Hard floor scrub attachment for cleaning tiles and sealed wooden floors.

2. 2-in-1 tool

A smaller cleaning tool to keep messy clean ups separate from every day cleaning.

- C) Multi-purpose brush attachment for cleaning carpets, rugs, sofas and upholstery.
- D) Hard floor scrub attachment for cleaning tiles and sealed wooden floors.

3. Tight Spot tool

For edge and tight spot/crevice cleaning.

4. Pet tool

This tool is designed to lift pet messes around your home.

NOTE: Pet tool only included with model F18OPSC23K.



Press the tool release button and slide the tool onto the end of the hose, over the nib. Release the button when in place.

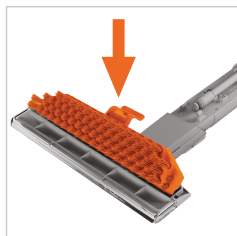

To fit an attachment to the wash tool, fit the front of the selected attachment into the front of the wash tool and push the clip down to click into place.

USING THE WIDE PATH TOOL (1) OR 2-IN-1 TOOL (2)



For spills, always pick up the excess liquid before using water/solution. Tilt the tool forward onto the spill and pull back.



Press the trigger on the hose to release water and solution.

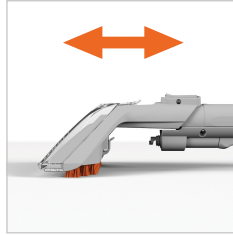

Use the brush to agitate any stubborn stains, scrubbing back and forth.

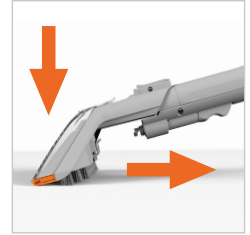

Tilt the nozzle forward so the nozzle is in contact with the surface. Pull back to recover the water and solution.

USING THE TIGHT SPOT TOOL (3)



Press the trigger on the hose to release water and solution.

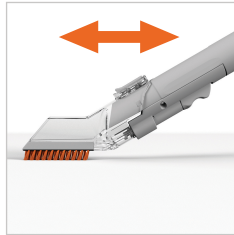

Use the brush to agitate any stubborn stains, scrubbing back and forth.

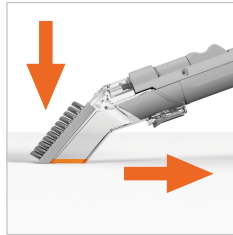

Turn the tool over and tilt the nozzle forwards so the nozzle is in contact with the surface. Pull back to recover the water and solution.

IMPORTANT: Over- or under-tilting the tool may result in poor water pick up:



CLEANING AND MAINTENANCE

EMPTYING AND CLEANING THE DIRTY WATER TANK

IMPORTANT: Always switch off the machine and remove the battery before performing maintenance or troubleshooting checks.

The dirty water tank is fitted with a float. When the dirty water tank is full, the float will shut off the suction on the machine. You will be able to hear if this has happened as the motor noise on the machine will increase. Once the float is activated, empty the dirty water tank if full. If the dirty water tank is not full then turn off your machine at the power switch and wait for the float to settle.

Empty and rinse out the clean water/solution tank and dirty water tank and leave to air dry before refitting to store.

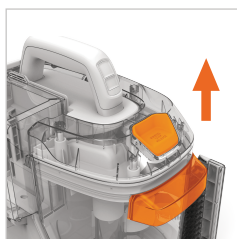

Press the dirty water tank release button. Pull to release the tank and lift by the carry handle to remove.



Pull and lift the lid to remove from the dirty water tank.

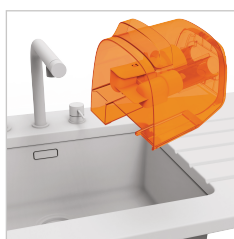

Empty the dirty water into the sink or toilet.



Rinse the dirty water tank and lid under water (max 40°C) to remove dirt/debris.



To refit the lid align the lid to the tank and firmly push into place.



Refit the dirty water tank onto the machine so it clicks into place.

CLEANING THE HOSE

IMPORTANT: Clean the hose after each use to remove any debris or water left in the hose.

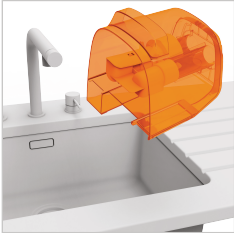

Empty the dirty water tank into the sink or toilet and refill onto the machine.

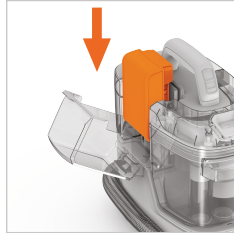

Holding the cover open, slide the battery into the machine until it clicks into place. Close the battery cover.

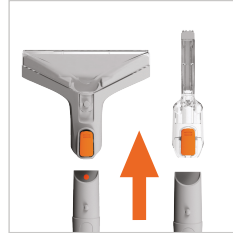

Press the tool release button and pull to remove the tool from the hose.



Fill a bowl with a maximum 500ml of warm water (max 40°C) (no solution).



Press the on/off button to switch the machine on. Press the + button to increase the suction.



Submerge the end of the hose into the bowl of water. Do not squeeze the trigger.



Once the bowl is empty, let the machine run for 10 seconds to remove residual water and dirt left in the hose. Repeat the process again if needed.



Press the on/off button to switch the machine off.

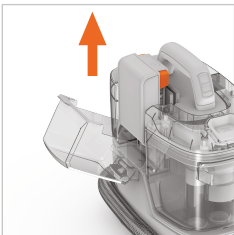

Open the battery cover, press and hold the side buttons on the battery and pull to remove.

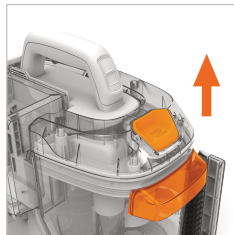

Press the dirty water tank release button. Pull to release the tank and lift by the carry handle to remove.



Pull and Lift the lid to remove from the dirty water tank.

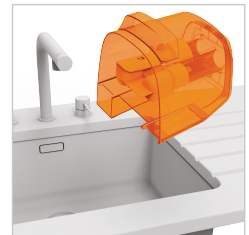

Empty the dirty water into the sink or toilet.

CLEANING AND MAINTENANCE

WARNING: Always switch off the machine and remove the battery before carrying out any maintenance or troubleshooting.

REMOVING AND CLEANING TOOLS/ATTACHMENTS



Press the tool release button and pull to remove the tool from the hose.



Pull and lift the clip to remove the attachment from the wash tool.



To remove the nozzle on the wash tool, push and lift the clear plastic clip up over the button on the end of the hose.



Rinse the tools, attachments and the nozzle under warm water (max 40°C) to remove dirt/debris.



To refit the nozzle, slide the nozzle into the wash tool until it clicks into place.

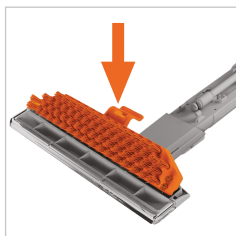

To refit, fit the front of the attachment into the front of the wash tool and push the clip down to click into place.

CLEANING THE FILTER GRILLE

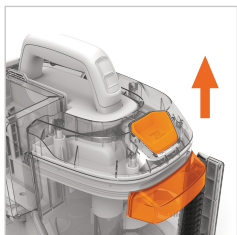

Press the dirty water tank release button. Pull and lift to remove the tank.



Remove any dirt and debris from the filter grille located underneath the dirty water tank.

There is an accessory missing

- Check the contents on the box.

Why does the machine have no power?

- The battery is not fitted correctly. See Assembly page 8.
- The battery has no charge. See Charging the battery page 7.
- The motor thermostat may have tripped. If this has happened remove the battery and allow the machine to cool for approximately 1 hour. Clean the filter grille and check the machine and hose for blockages before retrying.

Why won't the water/solution dispense?

- Squeeze the trigger on the hose to release solution and water mix. See Using the tools/attachments page 10.
- Make sure the clean water/solution tank is fitted securely. See Filling the water/solution tank page 9.
- The clean water/solution tank is empty. Refill the tank. See Filling the water/solution tank page 9.
- The clean water/solution tank valve may be stuck. Hold the tank over the sink and press the valve underneath to release.
- Air is trapped in the pump and hose. Switch on the machine, prime the pump by lowering the hose down to the floor and hold the trigger for up to 1 minute.

Why won't the machine produce suction?

- The float in the dirty water tank may have been activated. Empty the dirty water tank and wait for the float to settle before restarting your machine.
- The tool nozzle may not be in contact with the surface, tilt the nozzle forwards. See Using the tools/attachments page 10.
- Check the tool for blockages and clear. See Removing and cleaning tools/attachments page 14.
- Check the hose for blockages, clean the hose, and retry. See Cleaning the hose page 13.
- The dirty water tank may not be assembled correctly or the lid may not be fitted securely. See Emptying and cleaning the dirty water tank page 12.
- Check the tool is correctly fitted. See Using the tools/attachments page 10.
- Check the filter grille located under the dirty water tank for dirt and debris. See Cleaning the filter grille page 14.

Why is there a red light?

- Battery charge is running low. See Charging the battery page 7.



HOOVER.COM.AU
HOOVER.CO.NZ