



# POWER SCRUB XL CARPET CLEANER

MODEL: FACCW21TOK

## USER MANUAL

Please visit [Hoover.com](http://Hoover.com) for video instructions and FAQ's for this Carpet Cleaner.

IMPORTANT: READ ALL INSTRUCTIONS CAREFULLY BEFORE ASSEMBLY AND USE.

This product is intended for Household use only. If used Commercially warranty is VOID.

Questions or concerns?

For assistance, please call Customer Service at 1-300-698-130 from Australia, or 0-800-126-688 from New Zealand, Mon-Fri 9am-6pm EST before returning this product to the store.

## IMPORTANT SAFETY INSTRUCTIONS SAVE THESE INSTRUCTIONS

READ ALL SAFETY WARNINGS AND INSTRUCTIONS BEFORE USING THIS PRODUCT.

**WARNING:** When using an electrical product, basic precautions should always be followed to avoid electric shock, fire, and/or serious injury, including the following:

**INTENDED USE** This machine is intended for household use only, for indoor carpet cleaning.

- Fully assemble product prior to use.
- Operate cleaner only at voltage specified on rating label on lower back of cleaner.
- Do not leave appliance when plugged in. Unplug from outlet when not in use and before cleaning or servicing.
- Use indoors only. Do not immerse in liquid. Use only on surfaces moistened by the cleaning process.
- To reduce the risk of fire and electric shock due to internal component damage, use only Hoover® cleaning fluids intended for use with this appliance.
- This appliance is not intended for use by persons (including children) with reduced physical, sensory or mental capabilities, or lack of experience and knowledge, unless they have been given supervision or instruction concerning use of the appliance by a person responsible for their safety. Children should be supervised to ensure that they do not play with the appliance.
- Use only as described in this user's manual. Use only HOOVER® recommended attachments.
- Do not use product with damaged cord or plug. If product is not working as it should, has been dropped, damaged, left outdoors, or dropped into water, call customer service at 1-300-698-130 from Australia or 0-800-126-688 prior to continuing use.
- Do not pull or carry by cord, use cord as a handle, close a door on cord, or pull cord around sharp edges or corners. Do not place product on cord. Do not run appliance over cord. Keep cord away from heated surfaces.
- Do not unplug by pulling on cord. To unplug, grasp the plug, not the cord.
- Do not handle plug or appliance with wet hands.
- Do not put any object into openings. Do not use with any opening blocked; keep free of dust, lint, hair, and anything that may reduce air flow.
- Keep hair, loose clothing, fingers, and all parts of body away from openings and moving parts.
- Turn off all controls before unplugging.
- Use extra care when cleaning on stairs. To avoid personal injury or damage, and to prevent the cleaner from falling, always place cleaner at bottom of stairs or on floor. Do not place cleaner on stairs or furniture, as it may result in injury or damage.
- Do not use to pick up flammable or combustible liquids, such as gasoline, or fine wood sandings, or use in areas where they may be present.
- Connect to a properly grounded outlet only. See Grounding Instructions.
- Do not pick up anything that is burning or smoking, such as cigarettes, matches, or hot ashes.
- Do not use without filters and tanks in place.
- Do not clean over floor electrical outlets.

## TECHNICAL SPECIFICATIONS

NAME	POWER SCRUB XL	WEIGHT	9.1kg
MODEL	FACCW21TOK	DIRTY WATER TANK	2.75L
VOLTAGE	220-240V~50Hz	CLEAN WATER TANK	3.75L
WATTAGE	1200W	HOSE LENGTH	3.5m
CORD	9M		



## CAUTION: TO REDUCE THE RISK OF DAMAGE:

- Avoid picking up hard, sharp objects with this product, as they may cause damage.
- Store appropriately indoors in a dry place. Do not expose machine to freezing temperatures.
- Do not use sharp objects to clean out hose as they can cause damage.
- To assist in reducing drying time, be certain the area is well ventilated when using detergents and other cleaners with this machine.
- To help prevent matting and resoiling, avoid contact with carpets until they are dry. Keep children and pets away from carpets until they are completely dry.
- Do not store extractor with solution in tanks.
- With brushes on, do not allow cleaner to sit in one location for an extended period of time, as damage to floor can result.
- Do not use this extractor on hard floors. Using this product on hard floors may scratch or damage your floor.
- Water will drip from the brushes and underside of the product after use and may puddle. To avoid damage to wood and laminate flooring and to avoid potential slip hazard, after use (a) do not leave the product on wood and laminate surfaces and remove to a hard surface and (b) place unit on absorbent material (such as a towel) to soak up drips.

## GROUNDING INSTRUCTIONS

This appliance must be grounded. If it should malfunction or breakdown, grounding provides a path of least resistance for electric current to reduce the risk of electric shock. This appliance is equipped with a cord having an equipment-grounding conductor (C) and grounding plug (A). The plug must be inserted into an appropriate outlet (B) that is properly installed and grounded in accordance with all local codes and ordinances.

**WARNING:** Improper connection of the equipment-grounding conductor can result in the risk of electric shock. Check with a qualified electrician or service person if you are in doubt as to whether the outlet is properly grounded. Do not modify the plug provided with the appliance - if it will not fit the outlet, have a proper outlet installed by a qualified electrician.

This appliance is for use on a nominal 240-volt circuit and has a grounding plug that looks like the plug (A) illustrated.

Hoover recommends the use of a Residual Current Device rating of 30mA or less.

Use only Australian approved 10amp extension cords. Care should be taken to arrange the extension cord to prevent it being a trip hazard

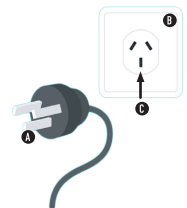

## DO'S

- Check with the manufacturer of your flooring prior to using the carpet washer.
- The clean water tank should be filled with warm water (max 40°C) only. Filling the clean water tank with hot or boiling water will damage the machine and invalidate the warranty.
- Always vacuum your flooring thoroughly before using the carpet washer.
- Test all carpets/rugs/upholstery before full usage. Run the carpet washer over a small hidden area. If no damage or pile distortion occurs continue cleaning.
- Always unplug the carpet washer before carrying out any maintenance and before connecting or disconnecting the hose/accessories.
- Always check tools and accessories are free from damage, dirt and debris before using.
- Take extra care when cleaning on the stairs.
- Always protect the power cable from heated surfaces or near open flames.
- Turn off all controls on the carpet washer before disconnecting or connecting the power cord. After use always wrap the power cord around the cord clips provided.
- Always keep the power cord away from the brushes whilst using the carpet washer.
- Use only Australian/New Zealand approved 10amp extension cords, non-approved extension cords may overheat. Care should be taken to arrange the extension cord as it can be a trip hazard.
- Always use the carpet washer with all water/solution tanks and filters in place.
- Keep all openings clear and free from debris as this may affect the airflow/suction.
- Always use the carpet washer in an upright position. To prevent motor damage from dirty water, never hold the carpet washer upside down or on its side.
- Store the carpet washer in a cool, dry area. Before storing the carpet washer please ensure all water/solutions tanks and filters are thoroughly clean and dry.

## DON'T'S

- Don't leave the carpet washer plugged in when unattended.
- Don't use the carpet washer if it has been dropped, damaged or left outdoors.
- Don't run over the power cord or use the carpet washer if the power cord or plug is damaged. If the supply cord is damaged, it must be replaced by a qualified person in order to avoid a hazard.
- Don't use the carpet washer to pick up any flammable or combustible materials (lighter fluid, petrol, kerosene etc.) or use the carpet washer in an area with explosive vapours or liquid.
- Don't handle the plug or use the carpet washer with wet hands.
- Don't pull or carry the carpet washer by the power cord.
- Don't use the carpet washer to pick up hot coals, cigarette butts, matches or smoking hot burning items or use in an area where there may be harmful fluids (chlorine, bleach and ammonia drain cleaner).
- Don't use the power cord as a handle, pull the power cord around corners or sharp edges, or close a door over the power cord.
- Don't unplug the carpet washer by pulling on the power cord.
- Don't carry the carpet washer while it's switched on.
- Don't attempt to remove blockages with sharp objects as this may cause damage to the carpet washer.
- Don't use the carpet washer with incorrect voltage as this may result in damage or injury to the user. The correct voltage is listed on the ratings label.

Subject to technical change without notice.



For assistance, please call  
1-300-698-130 Australia  
0-800-126-688 New Zealand



Please visit [Hoover.com.au](http://Hoover.com.au) (AUS) or [Hoover.co.nz](http://Hoover.co.nz) (NZ) for video instructions and FAQ's



Replacement parts and accessories such as solutions available at [Hoover.com.au](http://Hoover.com.au) (AUS) and [Hoover.co.nz](http://Hoover.co.nz) (NZ)

IPX4



# GETTING STARTED

## ASSEMBLY

Fully assemble product prior to use.

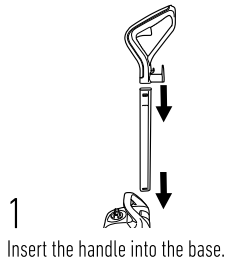

1 Insert the handle into the base.

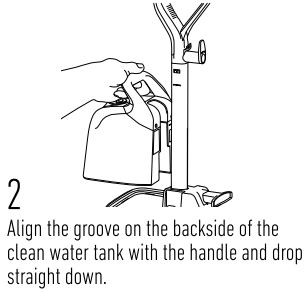

2 Align the groove on the backside of the clean water tank with the handle and drop straight down.

## OPERATION

**CAUTION:** DO NOT USE THIS EXTRACTOR ON HARD FLOORS. USING THIS PRODUCT ON HARD FLOORS MAY SCRATCH OR DAMAGE YOUR FLOOR.

**CAUTION:** Use extra care when cleaning on stairs. To avoid personal injury or damage, and to prevent the cleaner from falling, always place cleaner at the bottom of stairs or on floor. Do not place cleaner on stairs or furniture, as it may result in injury or damage.

**WARNING:** To reduce the risk of personal injury, unplug before cleaning or servicing.

## FILL THE CLEAN WATER TANK

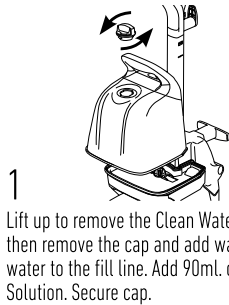

1 Lift up to remove the Clean Water Tank, then remove the cap and add warm water to the fill line. Add 90ml of Hoover Solution. Secure cap.

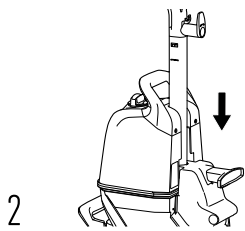

2 Align the tank and firmly press it into place.  
**NOTE:** Test for colorfastness in a small, hidden area. Gently rub surface with a dampened white cloth. Wait ten minutes and check for color removal or bleed with a white paper towel.  
**NOTE:** For the best results, vacuum carpet and upholstery thoroughly with a HOOVER® vacuum before use.

## CLEANING MODES

There are two cleaning modes available with the Power Scrub XL. Deep Clean, for embedded dirt and stains, and Quick Clean for surface level cleaning.

## QUICK CLEAN

To engage Quick Clean Mode, turn knob counterclockwise until engaged.

## DEEP CLEAN

To engage Deep Clean Mode turn the knob clockwise.

## HOW TO USE

1 Plug the cord into an electrical outlet.

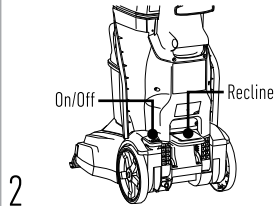

2 Turn unit ON/OFF with side pedal.

3 Recline unit with the middle pedal.

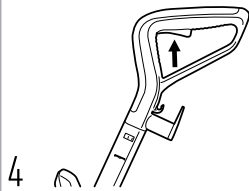

4 Squeeze trigger to apply water and cleaning solution.

5 Slowly push forward with trigger pressed to wash, then slowly pull backwards with trigger released to dry.

**NOTE:** For Best Results, rinse the carpet after deep cleaning with clean water only. This will remove residual carpet cleaning solution from your carpets. To rinse with clean water only, remove the solution tank from the unit and then repeat steps 4 and 5.

## EMPTY THE RECOVERY TANK

**NOTE:** To maintain proper suction, empty Tank when Red Bobber is visible.

1 Turn the cleaner off and unplug from electrical outlet.

2 Grab the Recovery Water Tank handle and lift up and outward to remove it. A second handle is provided on the back of the Recovery tank for carrying the tank.

3 Unlatch the tank lid and empty it. Rinse and allow to air dry.

## USING THE HOSE

**CAUTION:** Always turn off appliance before connecting or disconnecting hose.

**CAUTION:** Not to be used for grooming a pet.

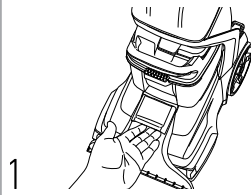

1 Attach hose by opening the Hose Connection Port on the nozzle.

2 Hold open the Hose Solution Port door. Plug the Hose Solution Tube connector firmly into the Hose Solution Port.

3 To drain the hose, run the unit and do not press the spray button on the hose/ tool end.

## REMOVING THE HOSE

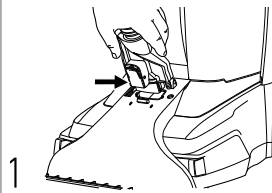

1 Press the button and firmly pull up to remove the Hose Solution Tube from the Solution Port.

2 The Hose port Door is spring loaded to close automatically. Ensure the Hose Port Door is fully shut for the best performance.

**NOTE:** To ensure maximum performance and to protect your carpet, be sure to place the handle in the upright position while using the hose.

## HOW TO USE TOOLS

**CAUTION:** To reduce the risk of injury from moving parts - Unplug before connecting SpinScrub® Hand Tool. Not to be used for grooming pets.

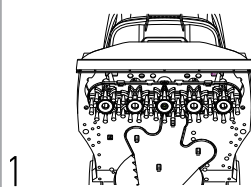

1 Place the handle in the upright position. This will shut off the SpinScrub® brushes.

2 Connect tool to hose by sliding it onto the connector until it locks into place.

3 Using your thumb, push forward and up on the latch to remove tool.

**NOTE:** The Antimicrobial pet tool included with select models only has a button to release the tool from the hose.

## HOW TO USE TOOLS (CONT'D)

4 Turn cleaner ON.

5 Pre-spray the carpeted stair or raised surface by holding the tool about 2-3cm above the carpet and push it forward while pressing the trigger.

6 Position tool against the stair or raised surface and slightly press it into carpet pile. Spray the carpet by pressing the trigger while pulling the tool slowly over the carpet. Release trigger at end of stroke.

7 Lift tool, and position it against stair or raised surface. Pull tool slowly over carpet without pressing trigger.  
**NOTE:** Overlap strokes by 1-2cm to help prevent streaking.

## MAINTENANCE

**WARNING:** To reduce the risk of personal injury, unplug before cleaning or servicing.

**IMPORTANT:** To prevent possible leaking, remove Clean Water Tank and Dirty Water Tank.

This product contains no serviceable parts. If appliance is not working as it should, has been dropped, damaged, left outdoors, or dropped into water, call customer service at 1-300-698-130 (AU) or 0-800-126-688 (NZ) prior to continuing use.

**LUBRICATION:** The motor is equipped with bearings which contain sufficient lubrication for their lifetime. The addition of lubricant could cause damage. Do not add lubricant to motor bearings.

**CORD STORAGE:** Wrap the power cord around the cord hooks for convenient storage. Attach the plug end to the cord.

## NOZZLE CARE

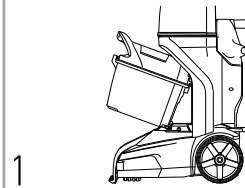

1 First turn off and unplug the carpet cleaner. Remove Recovery Tank.

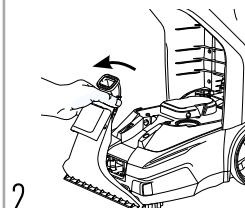

2 Pull up on the Nozzle slightly to release, then pull the Nozzle forward to remove it from carpet cleaner. Rinse with water and allow to air dry.

## FURTHER ASSISTANCE

**WARNING:** To reduce the risk of personal injury, unplug before cleaning.

## NOZZLE CARE (CONT'D)

3 To replace it, position Nozzle onto the front end while making sure to align the tabs at the bottom of the Nozzle with the notches on the foot.

4 Snap Nozzle to foot by swinging the nozzle into the lock position.

**IMPORTANT:** The nozzle must be in the proper position for the Dirty Water Tank to go on properly and for the unit to have proper suction.

## BRUSH CARE

1 Remove the tanks and place the handle in the upright position, tilt the cleaner back until handle rests on the floor.

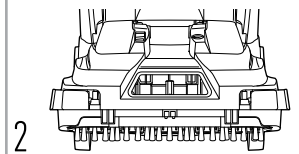

2 Push the latches out on the side of the foot until they lock open.

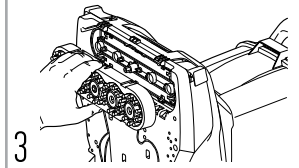

3 The Brush assembly should be free to pull out.

4 Rinse the brushes under running water.

5 Replace them by aligning the center drive post and note the arrows indicating the front of the machine. Push firmly until the latches lock into place.

THIS PRODUCT CONTAINS NO SERVICEABLE PARTS.

IF APPLIANCE IS NOT WORKING AS IT SHOULD, HAS BEEN DROPPED, DAMAGED, LEFT OUTDOORS, OR DROPPED INTO WATER, PLEASE CONTACT CUSTOMER SERVICE BEFORE CONTINUING USE. [AU 1-300-698-130] [NZ 0-800-126-688].